



## 82 Beresford Road, Gillingham, Kent, ME7 4EU

**\*\*GUIDE PRICE £240,000 TO £250,000\*\*\*\*\*OPEN DAY 8th OCTOBER\*\***

Close to many amenities including Medway hospital, Medway Park and Gillingham train station is this great two bedroom end of terrace home in Gillingham. The house has been extended to create a larger kitchen and has the added benefit of a utility room with W.C. and shower. The lounge diner is an open plan style and has access to a handy cellar, perfect for storage. To the first floor there are two double bedrooms and a family bathroom. The rear garden is of a good sized and there is also a front court yard garden. Added benefits include gas central heating and double glazed windows. We believe this could be the ideal first time home so call today to book your slot to view

**£240,000**

- 2 DOUBLE BEDROOMS
- UTILITY/SHOWER/CLOAKROOM
- OPEN PLAN LOUNGE/DINER
- EXTENDED KITCHEN
- REAR GARDEN
- PERMIT PARKING
- OPEN DAY 8th OCTOBER
- COUNCIL TAX BAND B
- VIEWING ADVISED

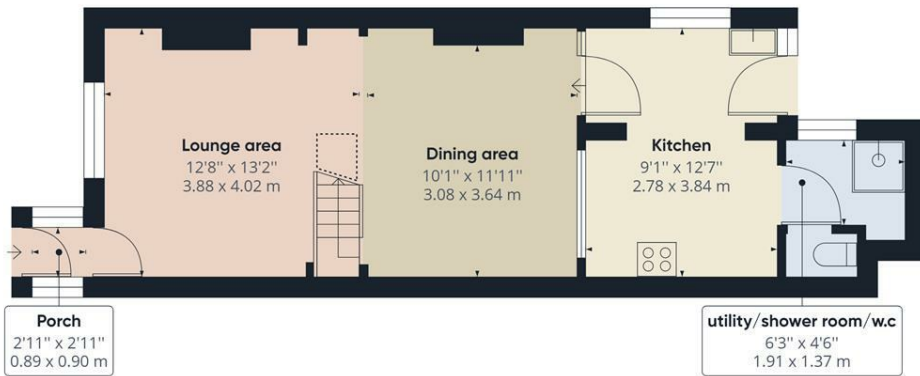

Ground Floor Building 1



Floor 1 Building 1

Approximate total area<sup>(1)</sup>

805.48 ft<sup>2</sup>  
74.83 m<sup>2</sup>

Reduced headroom

9.98 ft<sup>2</sup>  
0.93 m<sup>2</sup>

(1) Excluding balconies and terraces.

Reduced headroom (below 1.5m/4.92ft)

While every attempt has been made to ensure accuracy, all measurements are approximate, not to scale. This floor plan is for illustrative purposes only.

GIRAFFE360

